

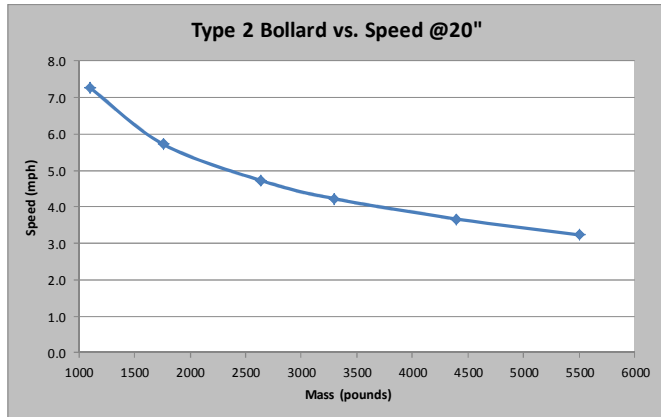

SlowStop Handicap Parking Bollard (4" Diameter)

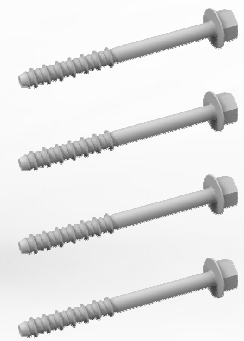

Installs with four (4) 5/8" x 5-1/2"
Concrete Anchor Screws



- Color:** Standard Yellow Bollard on Black Base
- Diameter:** 4" (3.5" ANSI Schedule 40)
- Bollard Height:** 42"
- Sign Height:** 60" above ground (ADA)
- Set Screws:** 5 M16 x 2.00
8mm Hex
- Fill:** Concrete pour by customer

SPECIFICATIONS

- Energy Absorption: 2,667 joules / 1,967 ft-lb.
- Temperature Rating: -40°
- Pipe Coating: 150µm Polyester Outdoor Powder Coat
- Cast Iron Coating: Environmentally friendly water-based KTL coating.
- HDPE sign on engineer grade sheeting
- Aluminum post and brackets included

RECOMMENDED USES

- Parking lot handicap parking spots
- Sign face can be changed for alternate uses
- Post-tensioned Concrete
- For use without costly wheel stops
- Avoid trip hazards in pedestrian travel lanes

IMPACTrecovery
SYSTEMS

"Performance for a Safer Tomorrow"

4955 Stout Dr. San Antonio, TX 78219
210.736.4477, 800.736.5256, fax: 210.734.6448
www.slowstop.com